

Floor plans

Ground Floor

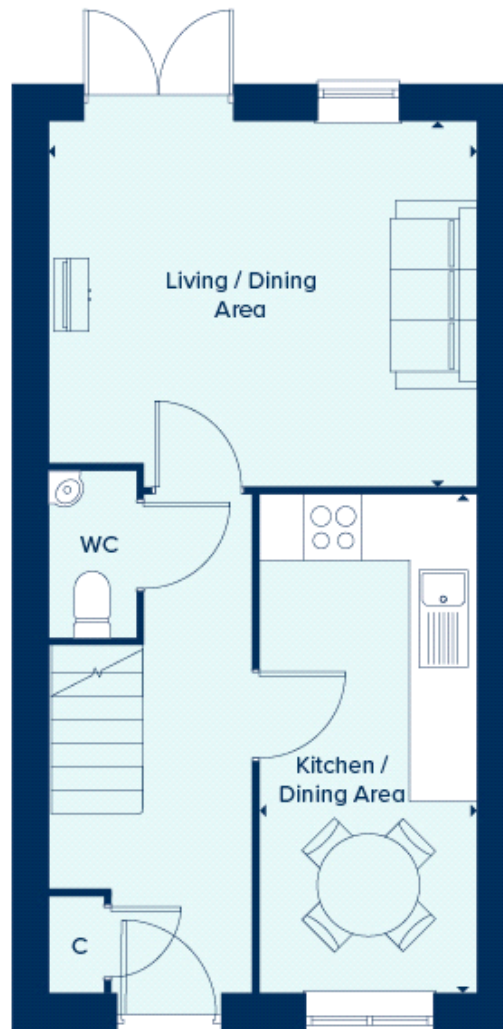

Kitchen/Dining Area:
4.85m x 2.11m (15' 11" x 6' 11")

Living/Dining Area :
4.17m x 3.56m (13' 08" x 11' 08")

First Floor

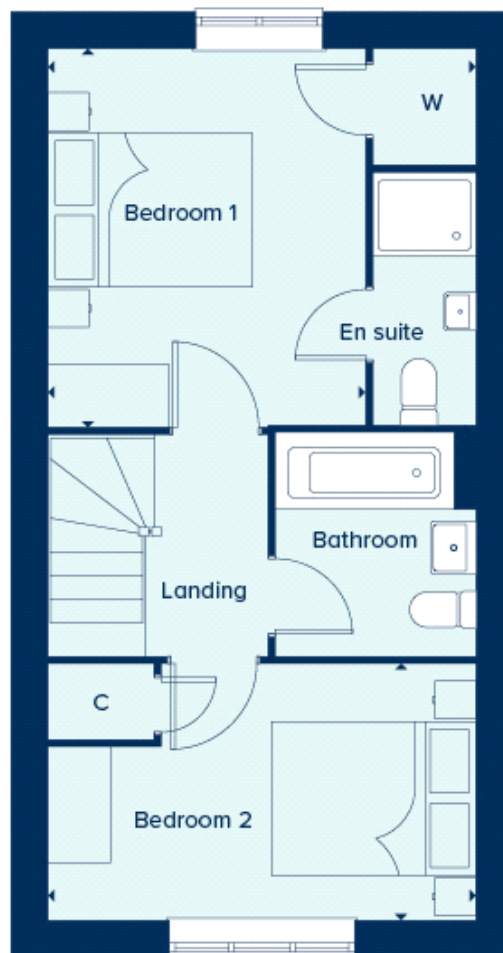

Bedroom 1:

3.68m x 3.07m (12' 01" x 10' 01")

Bedroom 2:

4.17m x 2.49m (13' 08" x 8' 02")