

Floor plans

Ground Floor

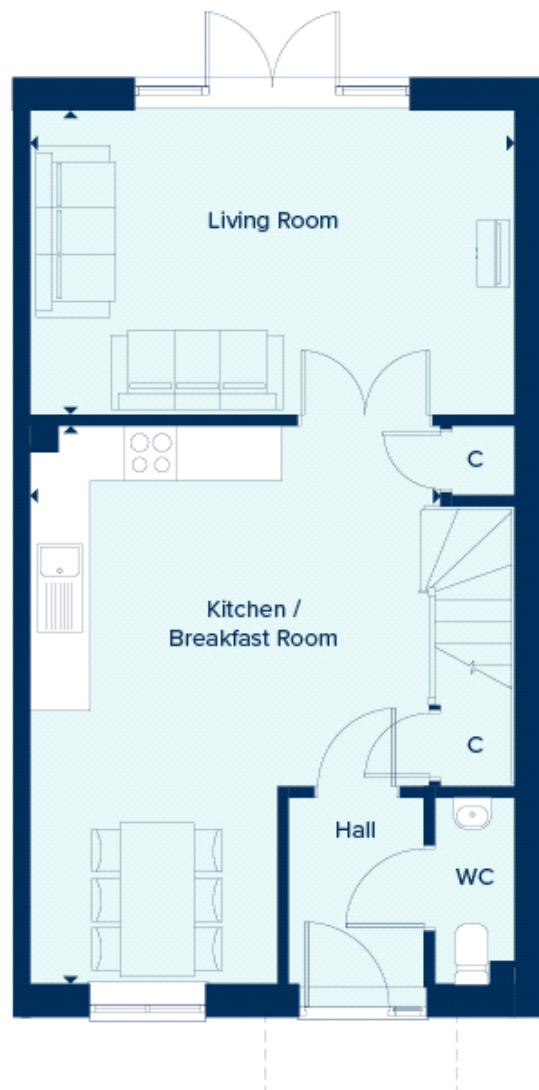

Kitchen/Breakfast Room:

3.11m x 4.44m (10' 02" x 14' 07")

Dining Area:

2.92m x 2.69m (9' 07" x 8' 10")

Living Room:

3.30m x 5.24m (10' 10" x 17' 02")

First Floor



Bedroom 1:

2.96m x 4.38m (9' 09" x 14' 04")

Bedroom 2:

4.96m x 2.96m (16' 03" x 9' 09")

Bedroom 3:

2.19m x 3.18m (7' 02" x 10' 05")