

Floor plans

Ground floor plan

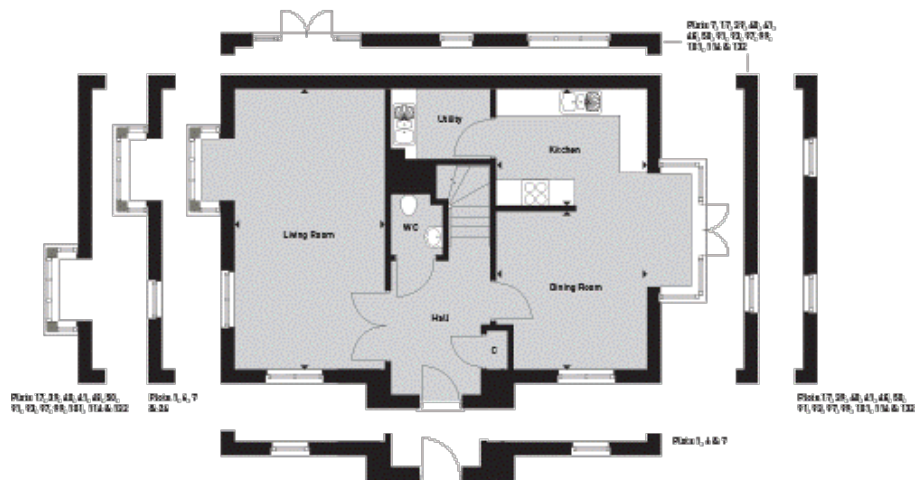

Living Room:

6.43m x 3.45m (21' 01" x 11' 04")

kitchen:

3.43m x 2.79m (11' 03" x 9' 02")

Dining Room:

3.63m x 3.43m (11' 11" x 11' 03")

First floor plan

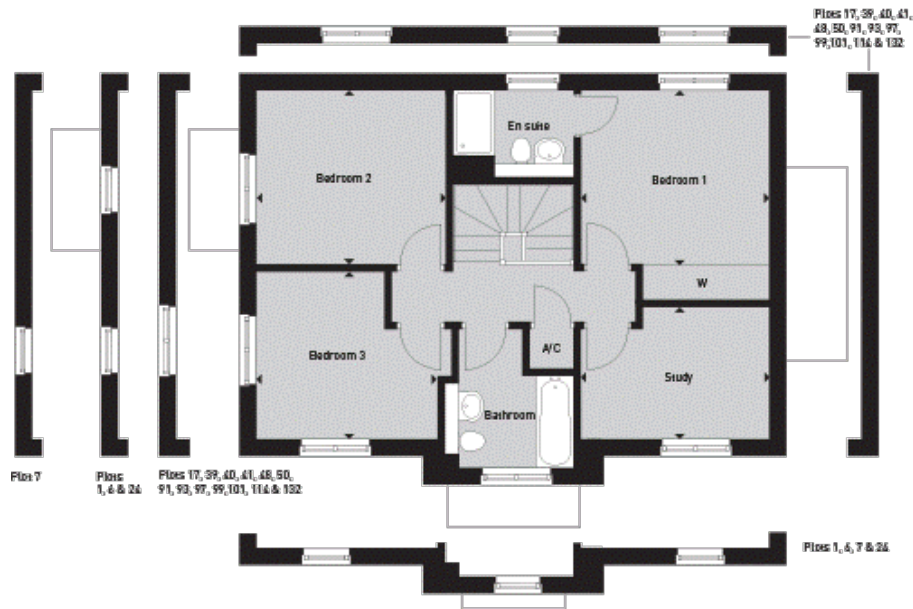

Bedroom 1:

3.89m x 3.48m (12' 09" x 11' 05")

Bedroom 2:

3.48m x 3.23m (11' 05" x 10' 07")

Bedroom 3:

3.33m x 3.07m (10' 11" x 10' 01")

Study:

3.48m x 2.41m (11' 05" x 7' 11")