

Floor plans

The Shipston

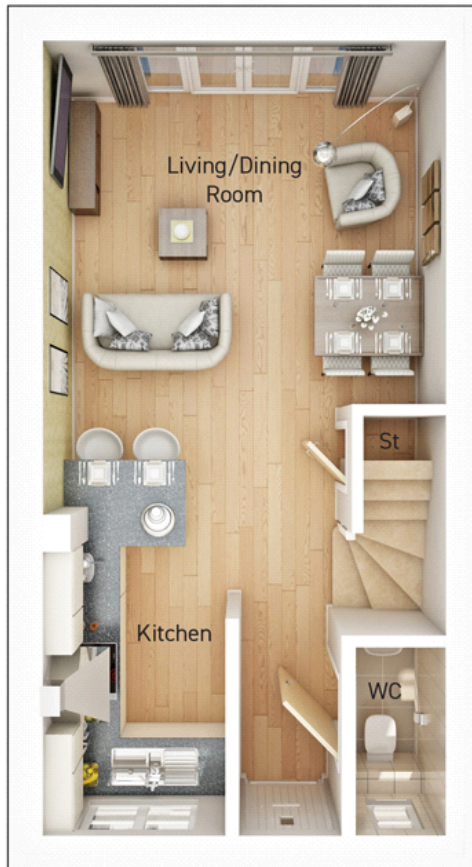

Living/Dining Area:
4.22m x 4.04m (13' 10" x 13' 03")

Kitchen:
3.71m x 1.83m (12' 02" x 6' 00")

Bedroom 1:
2.74m x 4.04m (9' 00" x 13' 03")

Bedroom 2:
2.79m x 4.04m (9' 02" x 13' 03")