

Floor plans

The Sutton

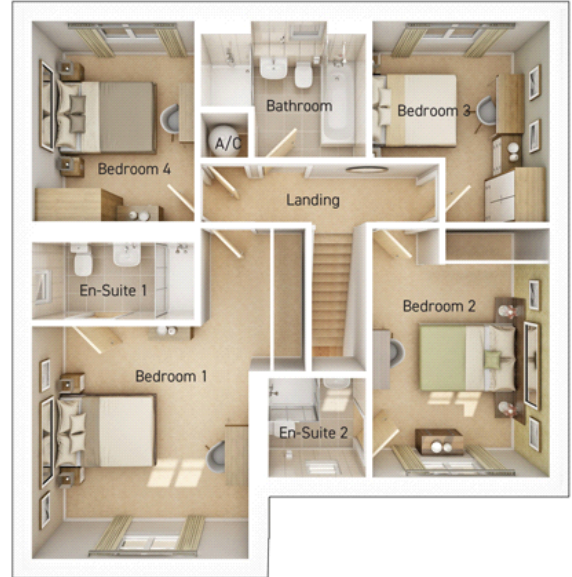

Living Room:

5.94m x 3.89m (19' 06" x 12' 09")

Kitchen/Dining Room:

3.61m x 5.99m (11' 10" x 19' 08")

Garden Room:

3.86m x 2.97m (12' 08" x 9' 09")

Bedroom 1:

4.17m x 3.89m (13' 08" x 12' 09")

Bedroom 2:

4.47m x 3.18m (14' 08" x 10' 05")

Bedroom 3:

3.61m x 3.18m (11' 10" x 10' 05")

Bedroom 4:

3.58m x 2.92m (11' 09" x 9' 07")