

## Floor plans

### The Norton

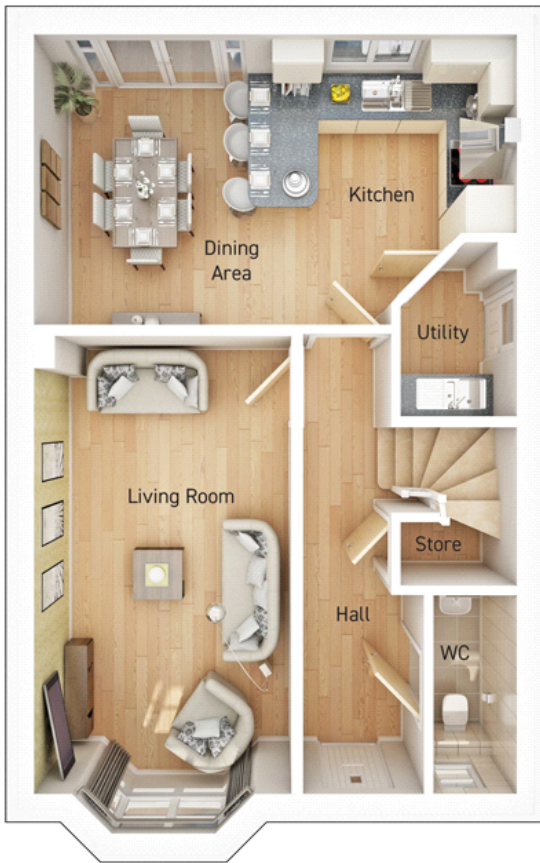

**Living Room:**

5.66m x 3.18m (18' 07" x 10' 05")

**Kitchen/Dining:**

3.58m x 5.97m (11' 09" x 19' 07")

**Bedroom 1:**

3.73m x 2.54m (12' 03" x 8' 04")

**Bedroom 2:**

2.54m x 3.58m (8' 04" x 11' 09")

**Bedroom 3:**

2.44m x 3.02m (8' 00" x 9' 11")

**Bedroom 4:**

2.36m x 3.02m (7' 09" x 9' 11")