

**Floor plans**

**Broadwell**

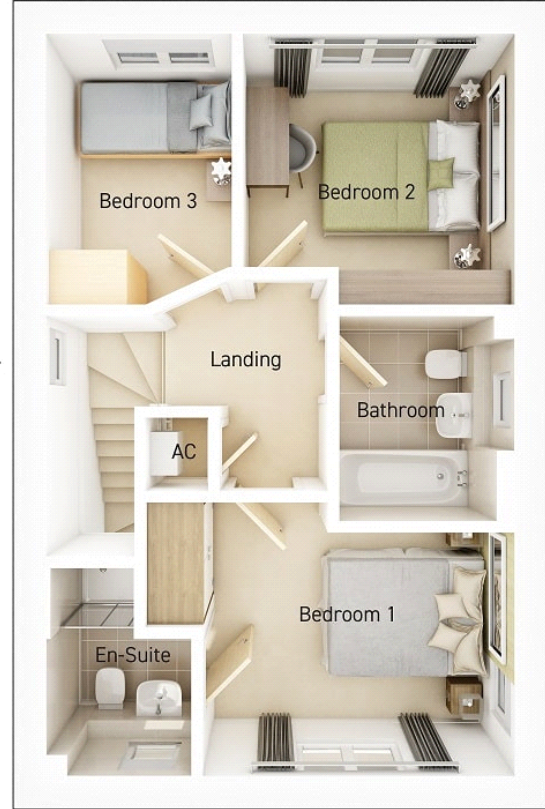
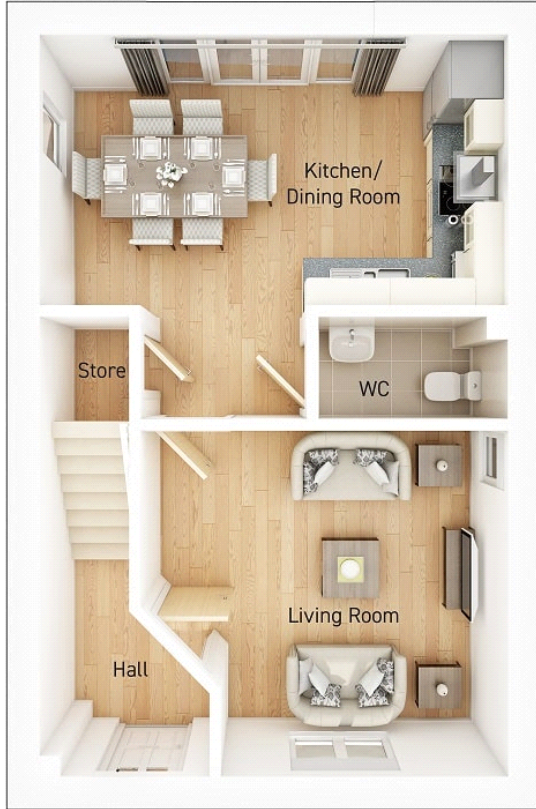

- Living Room:**  
3.71m x 3.94m (12' 02" x 12' 11")
- Kitchen/Dining Room:**  
2.90m x 5.00m (9' 06" x 16' 05")
- Bedroom 1:**  
2.62m x 3.33m (8' 07" x 10' 11")
- Bedroom 2:**  
2.90m x 2.92m (9' 06" x 9' 07")
- Bedroom 3:**  
2.90m x 1.98m (9' 06" x 6' 06")