

Floor plans

Floor Plan

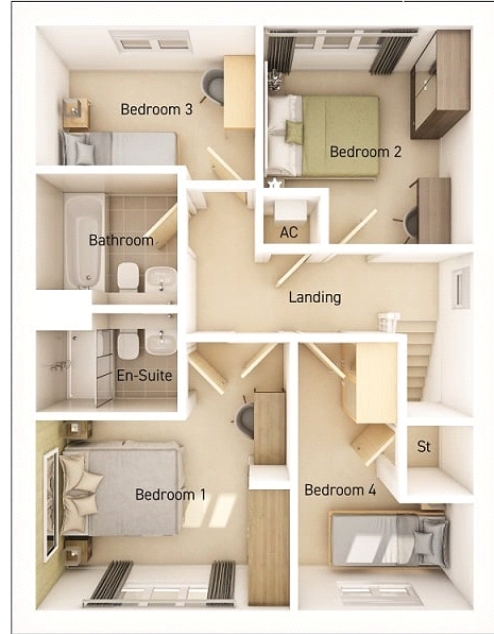

Chalgrove

- Living Room:**
3.96m x 4.17m (12' 12" x 13' 08")
- Kitchen/Dining:**
4.39m x 3.25m (14' 05" x 10' 08")
- Family Room:**
3.33m x 3.12m (10' 11" x 10' 03")
- Bedroom 1:**
2.77m x 3.68m (9' 01" x 12' 01")
- Bedroom 2:**
3.18m x 3.05m (10' 05" x 10' 00")
- Bedroom 3:**
2.03m x 3.20m (6' 08" x 10' 06")
- Bedroom 4:**
3.91m x 2.57m (12' 10" x 8' 05")