

Floor plans

Ground Floor Plan

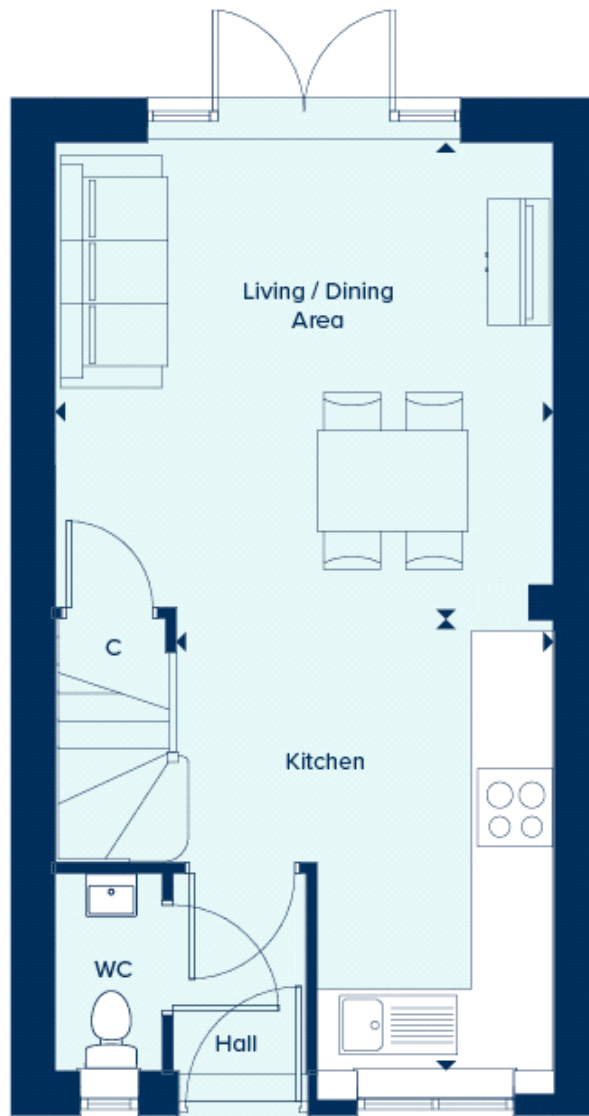

Kitchen:

3.58m x 2.100m (11' 09" x 9' 10")

Living/ Dining Room :

3.96m x 3.78m (13' 00" x 12' 05")

First Floor Plan

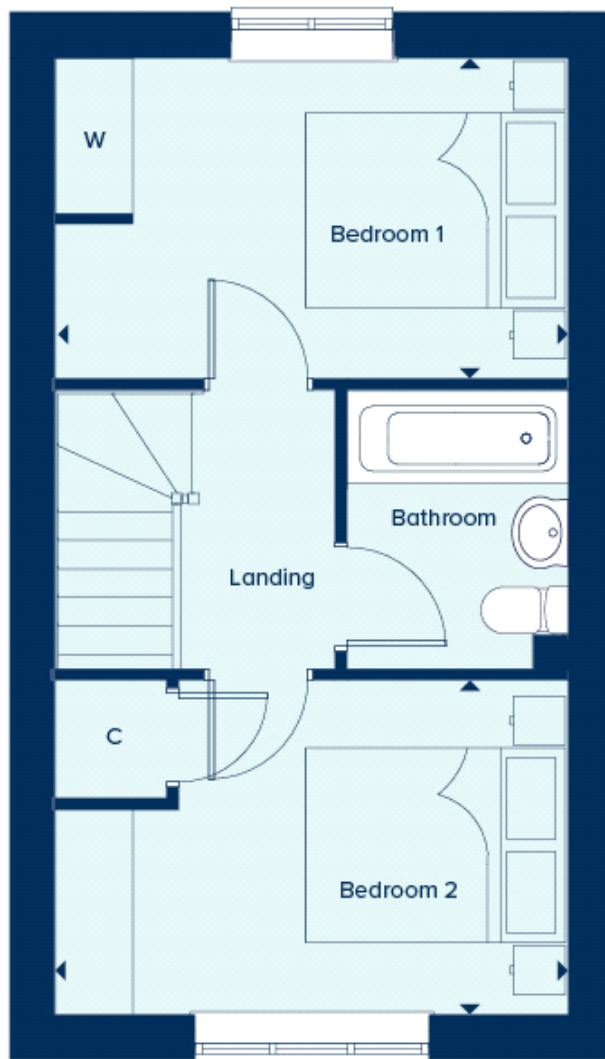

Bedroom 1:
4.19m x 2.46m (13' 09" x 8' 01")

Bedroom 2:
3.96m x 2.57m (13' 00" x 8' 05")