

## Floor plans

### Floor plan

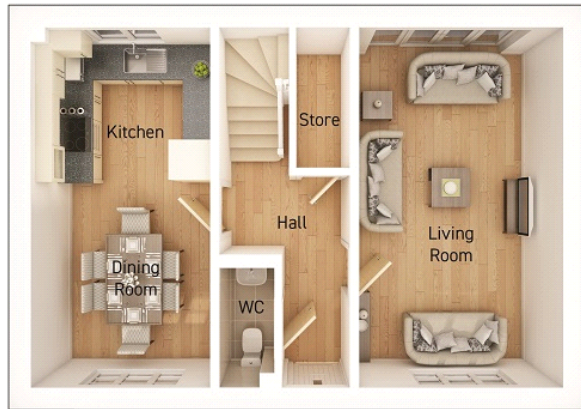

**Living room:**

5.64m x 3.20m (18' 06" x 10' 06")

**Kitchen/Dining:**

5.64m x 2.79m (18' 06" x 9' 02")

**Bedroom 1:**

4.09m x 3.05m (13' 05" x 10' 00")

**Bedroom 2:**

2.100m x 2.95m (9' 10" x 9' 08")

**Bedroom 3:**

2.51m x 3.23m (8' 03" x 10' 07")