

Floor plans

Floor plan

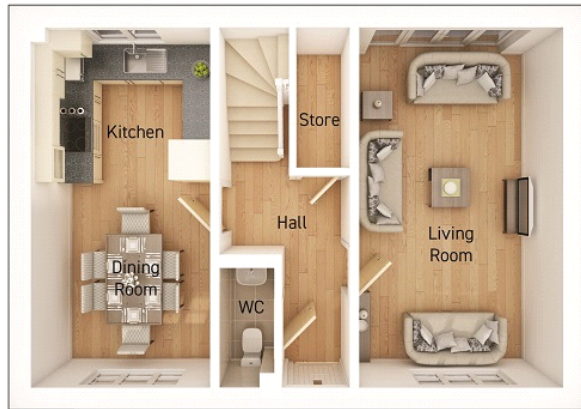

Living room:

5.64m x 3.20m (18' 06" x 10' 06")

Kitchen/Dining:

5.64m x 2.79m (18' 06" x 9' 02")

Bedroom 1:

4.09m x 3.05m (13' 05" x 10' 00")

Bedroom 2:

2.100m x 2.95m (9' 10" x 9' 08")

Bedroom 3:

2.51m x 3.23m (8' 03" x 10' 07")