

Floor plans

Floor plan

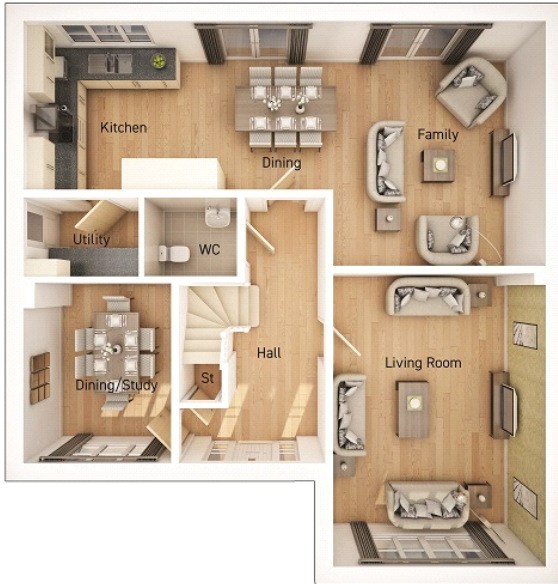

- Living room:**
5.74m x 4.17m (18' 10" x 13' 08")
- Kitchen/Dining:**
3.30m x 6.07m (10' 10" x 19' 11")
- Family area:**
4.80m x 4.17m (15' 09" x 13' 08")
- Study/Dining:**
3.53m x 2.90m (11' 07" x 9' 06")
- Bedroom 1:**
3.33m x 4.17m (10' 11" x 13' 08")
- Bedroom 2:**
3.45m x 4.17m (11' 04" x 13' 08")
- Bedroom 3:**
3.58m x 2.95m (11' 09" x 9' 08")
- Bedroom 4:**
3.58m x 2.87m (11' 09" x 9' 05")
- Bedroom 5:**
2.77m x 2.95m (9' 01" x 9' 08")