

Floor plans

Ground Floor Plan

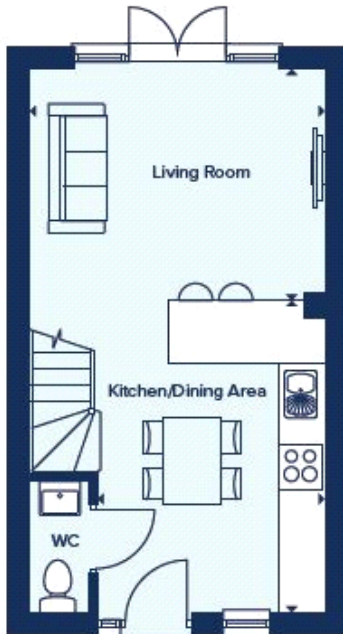

Living room:

3.30m x 4.19m (10' 10" x 13' 09")

Kitchen/Dining:

4.42m x 3.18m (14' 06" x 10' 05")

First Floor Plan

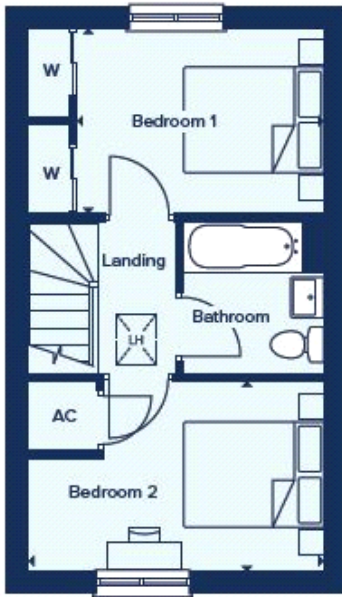

Bedroom 1:

2.64m x 3.51m (8' 08" x 11' 06")

Bedroom 2:

2.69m x 4.19m (8' 10" x 13' 09")