

## Floor plans

### Ground Floor Plan



**Living area:**

4.27m x 3.78m (14' 00" x 12' 05")

**Kitchen/Dining:**

4.83m x 3.38m (15' 10" x 11' 01")

## First Floor Plan

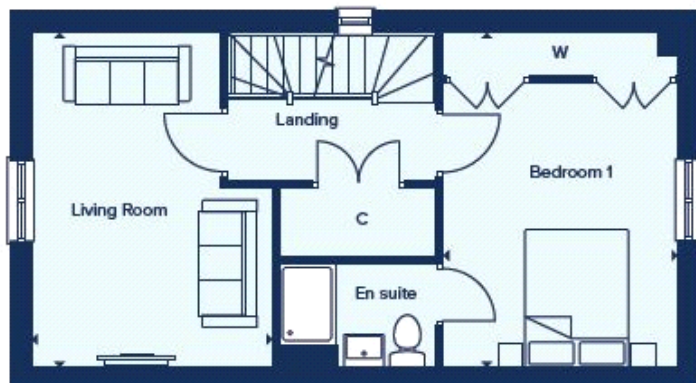

### Living room:

35.31m x 3.48m (115' 10" x 11' 05")

### Bedroom 1:

4.11m x 3.38m (13' 06" x 11' 01")

## Second Floor Plan

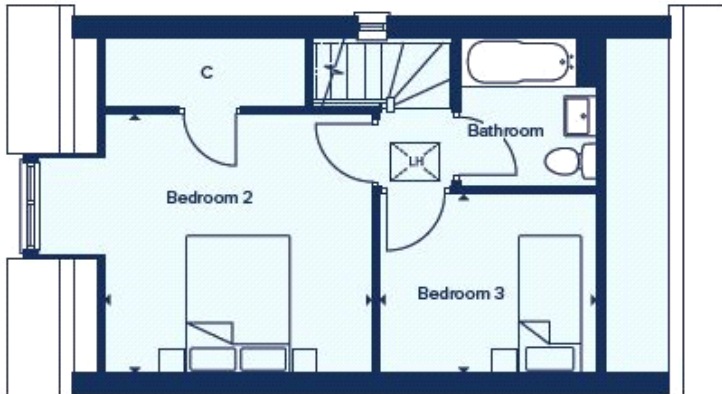

### Bedroom 2:

3.86m x 3.73m (12' 08" x 12' 03")

### Bedroom 3:

3.18m x 2.57m (10' 05" x 8' 05")